



Fontana Unified School District
Administration Complex

9680 Citrus Avenue
Fontana, CA 92335
909-357-7600

Accounting	22	Induction and Credentialing	14
Assessment & Evaluation	1	Infant Care Center (Tinker Tots)	39
Benefits	Bldg C	Internet Content Specialist	1
Business Services	1	John D. Piazza Education Center	3
Bus Pass Sign-Up	Bldg A	Language Assessment Center	Bldg A
Career Tech Education	1	Library	1
Categorical Programs	1	Medi-Cal	Bldg A
Central Records	Bldg A	Music, Elementary	21
Chief of Staff	1	Music Enrichment	37
Child Welfare & Attendance, Liaisons	Bldg B	Payroll	Bldg C
Community Clothes Closet	18	Police Services	8, 9, 10, 11
Comprehensive Health	Bldg A	Police Conference Room	19
Coordinator of Alternative Education	Bldg B	Police FLIP	20
Coordinator of Elementary Instruction	26	Public Information	1
Coordinator of Family and Communities	1	Purchasing	30
Director of College and Career	26	Restrooms	17
Director of Grants and Funding	1	Risk Management	22A
Director of Special Projects	1	Secondary, Chief of Schools	12
Early Childhood Education	27, 28, 29, 32, 35	SELPA - Program Spec. & Mental Health	34
Early Education - Administration	15A, 15B, 16	SELPA - Psychologists	31
Early Education - Enrollment	15A	SELPA - Special Education	33
Elementary, Chief of Schools	12	SELPA - Transitional Partnership Program	35
Emergency Operations Center	38	SELPA - VI, Orientation & Mobility	36
English Learners Services	1	Student Services	Bldg B
Enrollment Services	Bldg A	Superintendent	1
Fiscal Services	Bldg C	Teaching and Learning	1
Food Services	23, 24, 25	Technology	1
Gateway Program	40	Tinker Tots	39
Health Clinic	Bldg A	Translators	2
Human Resources - Certificated	4	Workers' Compensation	22A
Human Resources - Testing Center/Conference	5		
Human Resources - Classified	6,7		
Human Resources - Interviews	7		

Revised: April 16, 2015

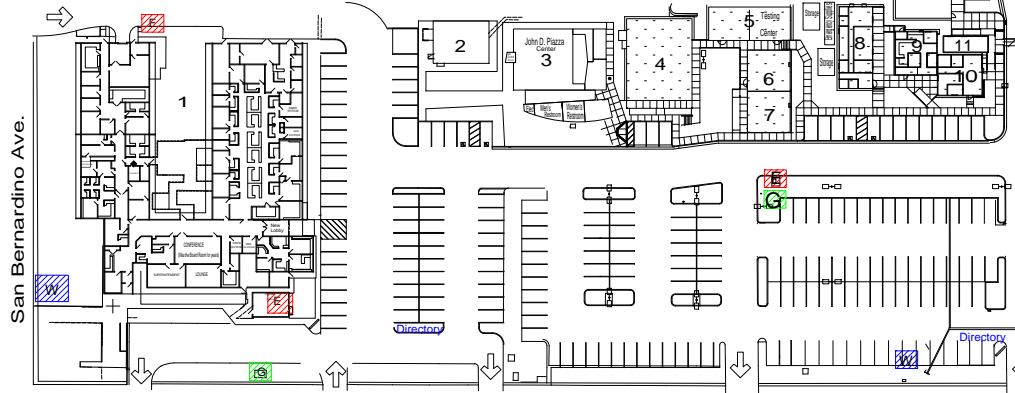
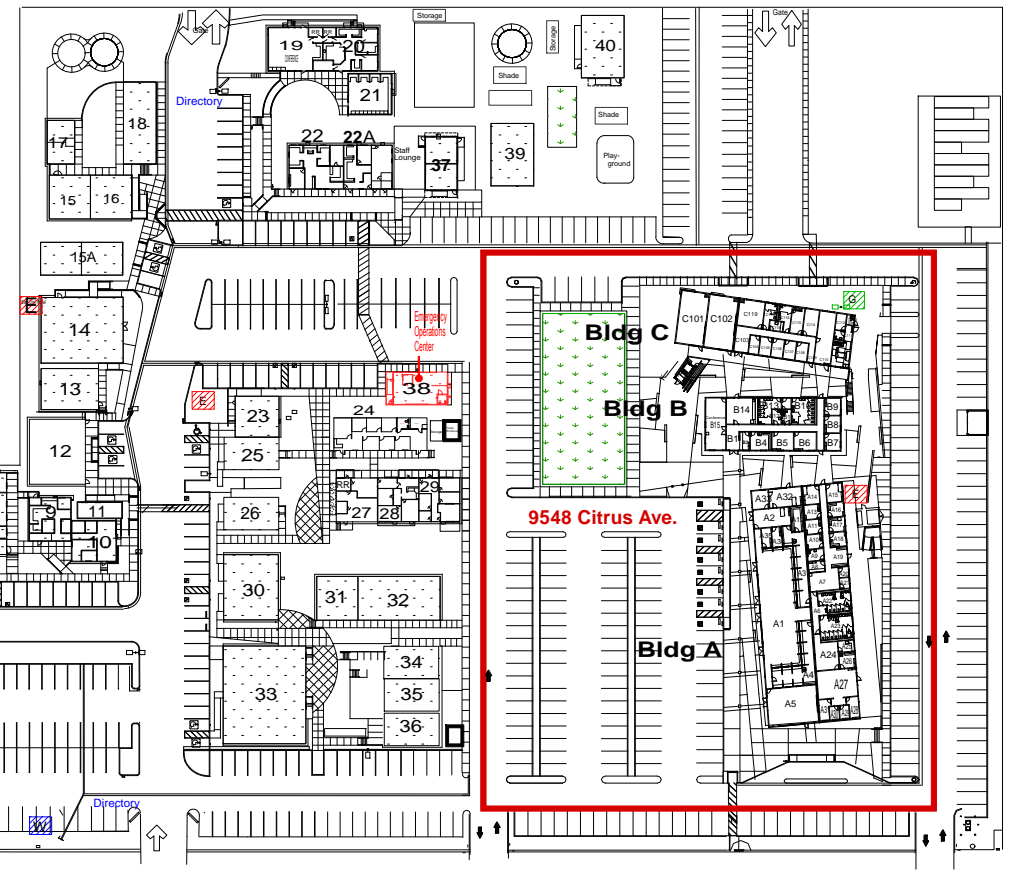

San Bernardino Ave.

Citrus Ave.

9548 Citrus Ave.



- = Portability
- = Electric
- = Water
- = Gas

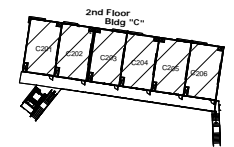

Opening Date: Sep, 1958
Acres: 14